

**MISCELATORE TERMOSTATICO  
IN ACCIAIO INOX A 2 O 3 VIE  
STAINLESS STEEL THERMOSTATIC MIXER  
2 OR 3 WAYS**

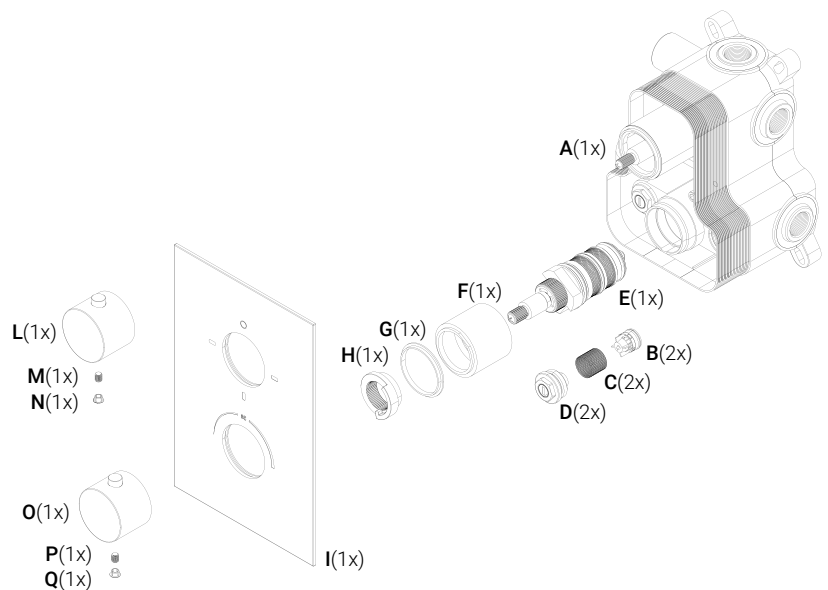



Min~0,05 MPa (0,5 bar)  
Max~1,00 MPa (10 bar)

0,3 MPa (3 bar)  
Cold 15°C  
Hot 65°C

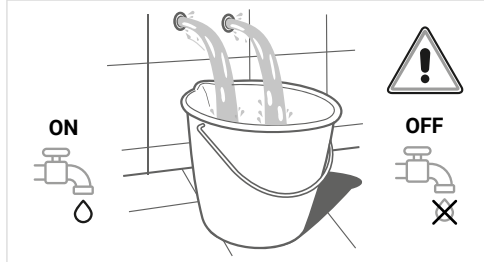

Min 4°C  
Max 29°C



Min 55°C  
Max 85°C

